



ASPIRE

— TO MOVE —



Norfolk Crescent, Bath, BA1

Video and physical viewing available. Ground floor two bedroom apartment located on Norfolk Crescent, Bath. Available unfurnished from 25th March 2025

Norfolk Crescent is located to the South West of Bath city centre and enjoys level access to local amenities such as Sainsbury's, 0.2 miles away and bars/restaurants 0.3 miles away. In front of Norfolk Crescent is a large open area perfect for relaxing or catching up with friends.

- Two bedrooms
- Norfolk Crescent
- Available 25th March 2025
- Unfurnished
- Close to local amenities
- Video viewing available
- Council tax band B
- Holding deposit £323.00

£1,400 Per month

Floor Plans

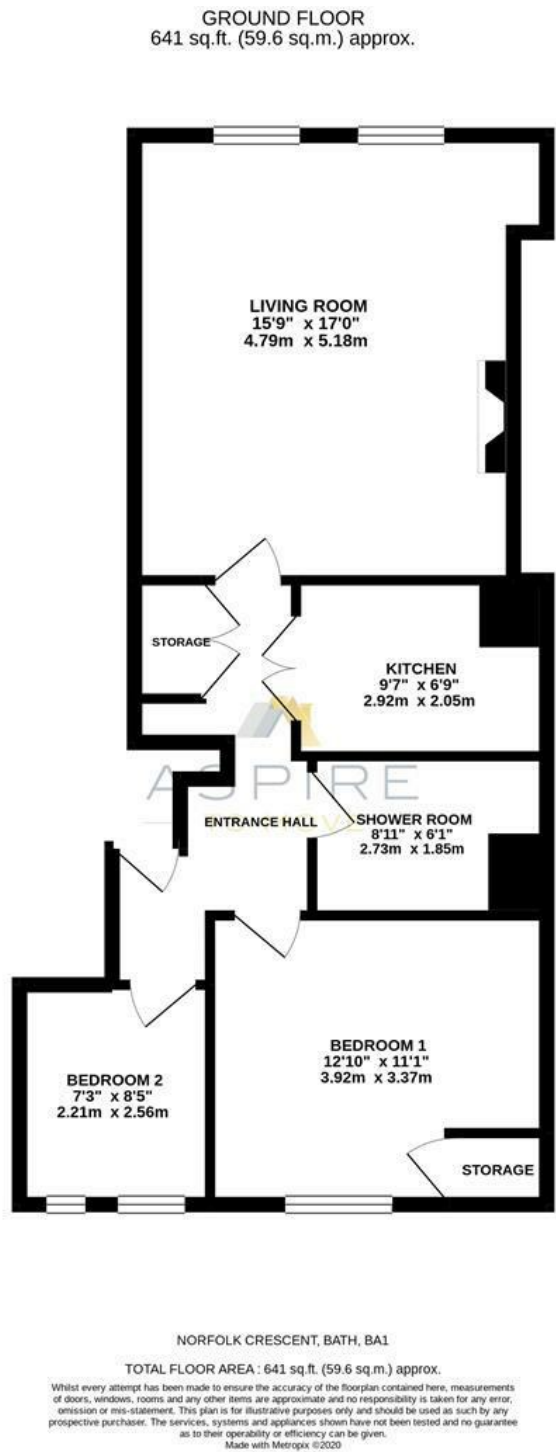

Energy Performance Graph

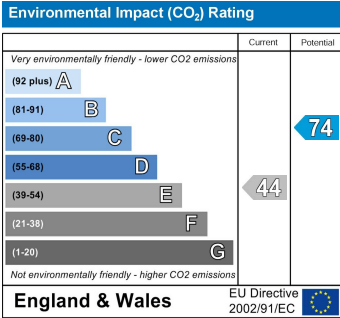
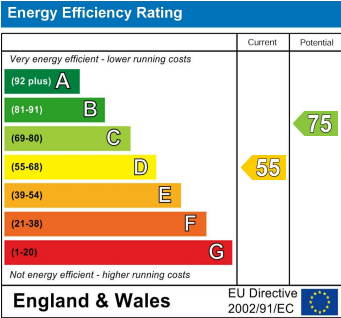

These particulars, whilst believed to be accurate are set out as a general outline only for guidance and do not constitute any part of an offer or contract. Intending purchasers should not rely on them as statements of representation of fact, but must satisfy themselves by inspection or otherwise as to their accuracy. No person in this firms employment has the authority to make or give any representation or warranty in respect of the property.